



Service Letter No: SL-200-082712

DATE: August 27, 2012

TO: All owners and / or operators of affected propellers

SUBJECT: Hydraulic cylinder (hub cap) screws

MODELS AFFECTED: **200RV, RV10 and 200A CONSTANT SPEED PROPELLERS
MANUFACTURED BETWEEN 05/03/2012 and 08/27/2012**

REASON: Propeller assemblies that use the 2012 "new" style 215 hub: The (14) hydraulic cylinder (hub cap) fastener holes are not tapped deep enough to allow the fasteners to be properly tightened. As such there is a possibility that the screws will crack or break over time.

TIMELINE: **MANDATORY / IMMEDIATE**

**DESCRIPTION OF
REQUIRED
CORRECTIVE
ACTION:** If the propeller has the "old" style round mounting flange **NO FURTHER
ACTION IS REQUIRED.**

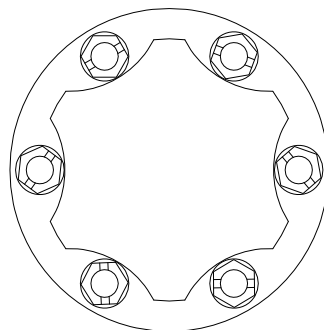

OLD STYLE
ROUND MOUNTING FLANGE

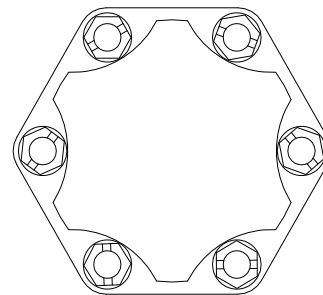

NEW STYLE
HEXAGONAL MOUNTING FLANGE

If the propeller has the "new" style hexagonal mounting flange contact Whirl Wind Aviation for a no cost correction kit that contains (14) flat washers and a tube of #242 Loctite.

Working on one screw a time, each of the (14) hydraulic cylinder (hub cap) #10-24 socket head cap screws must be removed, the kit flat washer installed under the screw head, Loctite applied and then reinstalled in the propeller hub. Tightened to 25 in. lbs.

Please notify Whirl Wind Aviation after completion of this work.